

# CAMP OVENS

Billmans Foundry have created 4 sizes in their Cast Iron Camp Oven range. Our camp ovens are cast using quality cast iron, we also use a blacksmith to hand forge the steel handles.

Proudly 100% Australian made and owned, Billmans Foundry continues the tradition of producing lasting products.

A great gift idea is to personalise the lid, with names dates etc. Billmans has created many personalised lids for weddings, birthdays etc making a gift that will last many years and can be handed down through family.

9"	6.75kg	3.9 litre	4 quart
12"	11.25kg	7.6 litre	8 quart
15"	16.25kg	14.1 litre	15 quart
18"	30kg	21.3 litre	22 quart



## BILLMANS FOUNDRY

Langslow Street (PO Box 242), Castlemaine  
Phone: (03) 5472 4302 Fax: (03) 5470 6933



Standard Billmans Camp Oven Lid

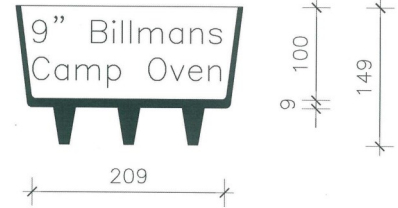
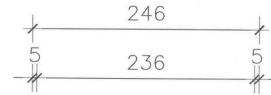

Weight: (handle included) = 5kg  
with lid = 6.75kg

**PERSONALISED LIDS:** The maximum letters/numbers/spaces for around the top of each oven is 16 , the same for around the bottom. The maximum letters/numbers/spaces for across the lid above the handle is 6.



12" Personalised Lid  
(Top & Bottom)



12" Personalised Lid  
(Around)

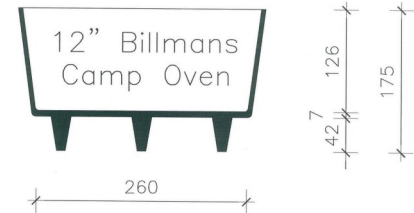
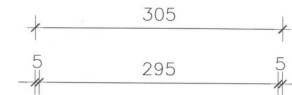

Weight: (handle included) = 7.5kg  
with lid = 11.25kg

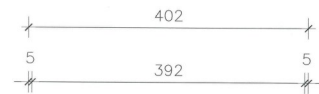

Weight: (handle included) = 11kg  
with lid = 16.25kg



15" Personalised Lid  
(Top & Bottom)



15" Personalised Lid  
(Top & Bottom)

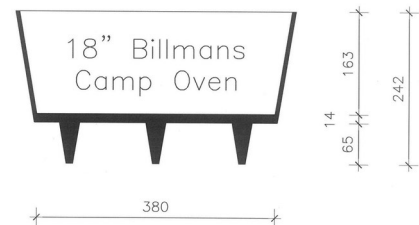
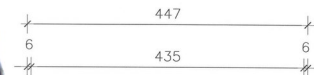

Weight: (handle included) = 23kg  
with lid = 30kg

**When ordering a Personalised Lid, the choices are for your lettering to run around the lid or top and bottom of the lid**